

# HAPPINESS & PEACE

UNDER ONE ROOF

*Walk-In*  
**Nirvana**

RESIDENTIAL  
APARTMENTS

Kadri Kaibattal, Karavali Lane,  
Mangalore - 2







Our promoter Mr Naveen D' Paula had started Walk-In Group, an organization dedicated towards the field of construction since 1994. Offering the best of our services, the principle objective of our firm is to offer the top-notch construction in a stipulated period.

With commendable time-longevity, we have been dealing with the civil and civil related works.

We have with us a fully computerized infrastructure enabling us fast and accurate project management reports, progress charts, bar charts, daily site progress report preparations for precise execution on site. State-of-the-surveying equipments and infrastructures enable us to provide our clients with the best.

# *Walk-In* Nirvana

RESIDENTIAL  
APARTMENTS

Kadri Kaibattal, Karavali Lane,  
Mangalore - 2

Walk-In Nirvana Residential Apartment is an embodiment of tranquility and modernity, designed for those seeking a retreat from bustling city life without forgoing its conveniences. Each apartment is a testament to luxurious living, with spacious interiors that are both luxurious and functional.

Strategically located at Kadri, Walk-In Nirvana offers easy access to the city's bustling business hubs, shopping centers, schools, and hospitals, making it a convenient place to live for professionals and families alike.

Experience the stay at Walk-In Nirvana, a personal sanctuary that keeps you in sync with the city's vibrant rhythm



# HAPPINESS & PEACE

UNDER ONE ROOF

*Walk-In*  
**Nirvana**  
RESIDENTIAL  
APARTMENTS

Kadri Kaibattal, Karavali Lane,  
Mangalore - 2



## SPECIFICATIONS

### General

- Fully framed R.C.C. structure with car parking facility in ground floor.
- Double coat exterior plastering with waterproof treatment.
- External painting of building with exterior anti fungal paint.
- UPVC windows with steel grill.
- Hardwood door frames with good quality decorative flush door for rooms and balconies.
- Overhead water tank and underground sump tank with required pumps.
- Well water in addition to the corporation water connection
- EV Charger points for all flats
- Biometric Access
- Children Play Area

### Drawing/ Dining

- Provision for T.V. connection.
- White coloured washbasin for dining.
- Calling bell provision.

### Bed Rooms

- Telephone and T.V. points in master bed room.
- A.C. provision in all bedrooms.

### Bath Rooms

- Water proof treatment done for sunken R.C.C. slab.
- Flush valves for commodes.
- Hot and cold mixer unit for all bathrooms.
- White coloured wall mounted E.W.C. in all toilets.
- Coloured ceramic tiles (anti skid) for bathroom floors & walls up to ceiling
- Health faucet in all bathrooms.
- Pressure checked plumbing and drainage lines to ensure total leak proof toilets.
- Fibrotech door frames & doors.

### Kitchen

- Granite platform with bullnozing.
- Stainless steel washing sink.
- Adequate power points and exhaust fan provision.
- Provision for fixing water purifier near the sink.
- Plumbing and drainage connection for washing machine
- Power point for washing machine/ grinder/ refrigerator.
- Reticulated gas connection provision





**HAPPINESS & PEACE**  
UNDER ONE ROOF

## TYPICAL FLOOR PLAN (First to Fifth)

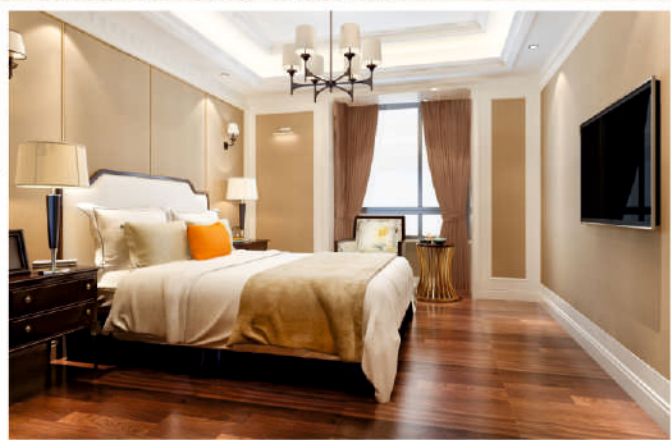
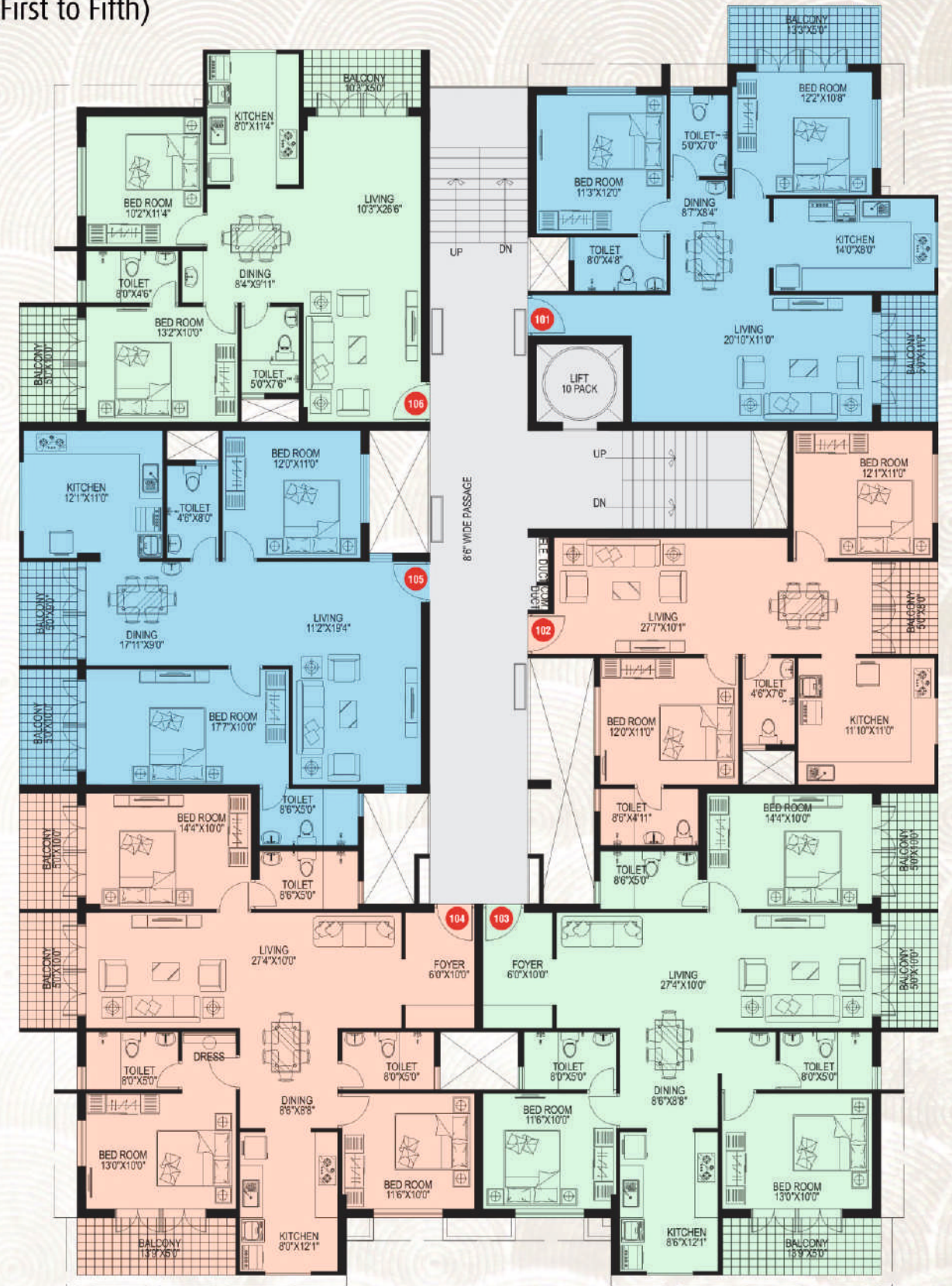

### HIGHLIGHTS

- 10 Passenger lift.
- Intercom facility.
- Solar hot water provision.
- C.C.T.V in common area.
- Gymnasium
- Generator (backing) full light soundproof enclosure.
- Hardwood frame and shutters for main entrance with melamine polish.
- Vitrified flooring for all rooms.
- Granite/marble flooring for common areas and staircase.

101 - 2BHK - 1210 sq.ft. | 102 - 2BHK - 1050 sq.ft. | 103 - 3BHK - 1610 sq.ft.  
104 - 3BHK - 1620 Sq.ft. | 105 - 2BHK - 1315 sq.ft. | 106 - 2BHK - 1190 sq.ft.

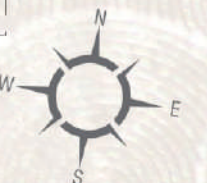



# LOCATION MAP



Scan For Location

## COMPLETED PROJECTS



**Delma Residency**  
K. Bhekar, Mangalore



**Walk-In Fantasy**  
Commander George Marth's Road, Kadri, Mangalore



**Walk-In Arcadia**  
Commander George Marth's Road, Kadri, Mangalore



**Walk-In Magnifica**  
K. Bhekar, Mangalore

## ONGOING PROJECT



**Louann Plaza**  
Panteshwar, Mangalore



**Walk-In Aikya**  
Bikarnikatte, Shashtri Nagar Road, Mangalore

Promoters:



City Hospital Building, Ground Floor,  
Kadri, Mangalore - 575 003  
Email: info@walkinbuilders.com  
www.walkinbuilders.com

Co Promoters:

**Mrs. & Mr. Vincent Nazareth**  
**Mrs. & Mr. Monthu Ligoury Dsilva**

Structural Consultants :

**Design Associates**

Hat Hill, Mangalore.

Engineers & Architects:



Bhoomika Towers,  
Bendoorwell, Mangalore.

For Booking Contact: 97411 27677, 73539 47677, 0824 2218677

This brochure is purely conceptual and is not a legal offering. The promoters / architects reserve the right to add / delete / alter any detail / specification / elevation mentioned herein.